



EMB-SF001

Emergency Battery Backup for ADS7R9

Project:

Location:

Qty:

Notes:



DESCRIPTION

Emergency battery backup for 7" slim surface LED model ADS7R9
Guarantees 90 minutes operation from battery in case of power outage

FEATURES & BENEFITS

Self test function
Switch time less than 1 second
Over charge / discharge protection
Durable die-cast aluminum with Li-ion battery
3 hours operating for model ADS7R9 at around 50% brightness
Photometric files for initial brightness, after 30 minutes and after 90 minutes discharging available on our website

DIMENSIONS OD 8" Thickness 1"

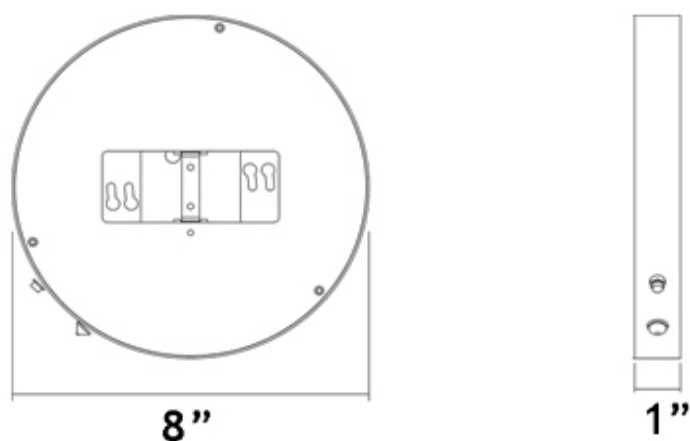

Fast & Easy Installation

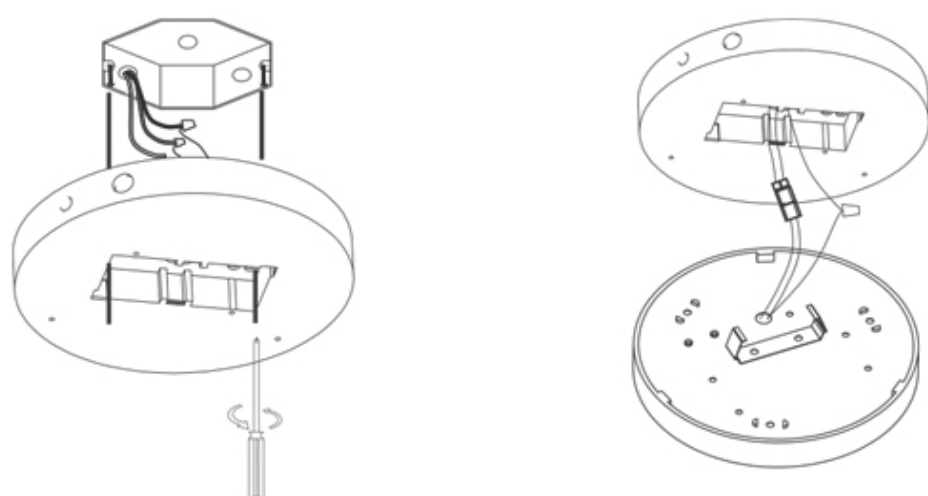

ORDERING GUIDE model **EMB-SF001**

SPECIFICATION	
Applications	Healthcare, Offices, Hotels, Hospitality, etc.
Input Voltage	120 V AC 50/60 Hz
Charging Time	24 hours
Charging Current	185 mA
Switching Time	< 1 second
Output Voltage	65 V DC
Discharging Time	3 hours with 90 minutes guaranteed
Brightness	around 50% of the full power
Output Current	45 mA
Output Power	3 W
Approved Location	Damp
Ambient Temperature	-4°F (-20°C) to +104°F (+40°C)
Certification	cETLus
Battery Life	500 Charging Cycles
Warranty	5 Year



ACCESSORIES Sold Separately



Empty Surface Mount Backbox of EMB-SF001
[model # EMBS](#)

COMPATIBLE FIXTURE

ADS7R9

Please note that only the single CCT 3000K and 4000K versions are compatible
ADS7R9-5CCT is NOT compatible

Lotus LED Lights USA
250 H Street # 301, Blaine WA 98230 tel 360-200-5500
Hainesport NJ, Naples FL, Vancouver WA

www.LotusLEDLights.com

mailing addresses
warehouses

Lotus LED Lights CANADA
702 Chester Rd, Delta BC V3M 6J1 tel 604-538-3090
Delta BC, Mississauga ON